

# NOW LEASING

## DYNAMIC ARDEN FAIR RETAIL LOCATION

NWC ALTA ARDEN & ETHAN WAY

SACRAMENTO, CALIFORNIA

For Further Information,  
Contact:

JON SCHULTZ  
(916) 446-8261  
jon.schultz@cbre.com

JULAINE JOHNSON  
(916) 446-8771  
julaine.johnson@cbre.com

555 Capitol Mall, Suite 100  
Sacramento, CA 95814  
Fax: (916) 446-8778  
www.cbre.com/sms

±4,187 SF AVAILABLE

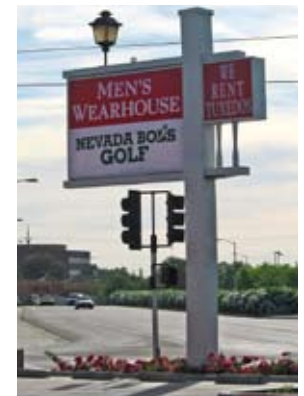

HOME OF THE NEW MEN'S WEARHOUSE ±9,200 SF FREESTANDING RETAIL BUILDING

cbre.com

1701 *Ethan Way*

**CBRE**  
CB RICHARD ELLIS

AREA MAP

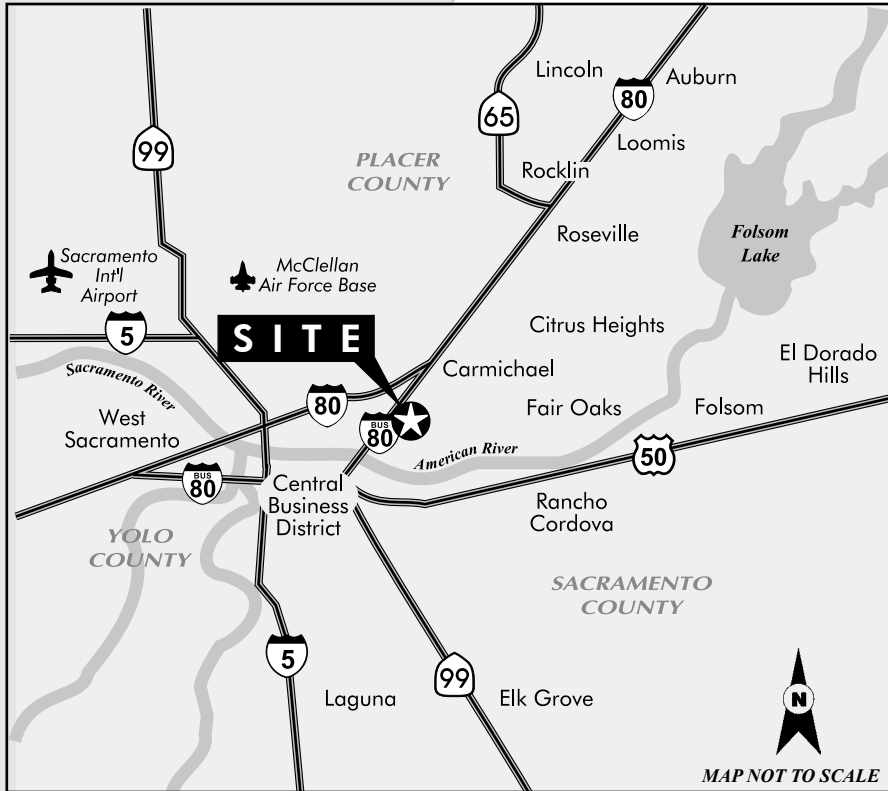

LOCATION MAP

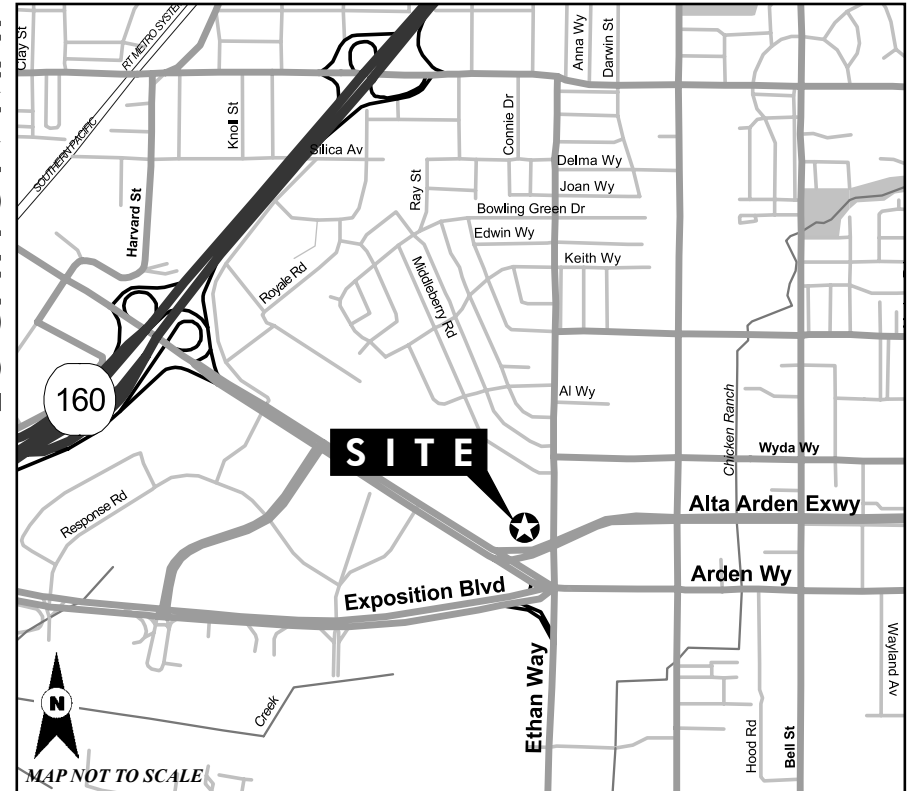

1701 ETHAN WAY  
NWC ALTA ARDEN & ETHAN WAY  
SACRAMENTO, CALIFORNIA

For Further Information,  
Contact:

**JON SCHULTZ**  
**(916) 446-8261**  
jon.schultz@cbre.com

**JULAINE JOHNSON**  
**(916) 446-8771**  
julaine.johnson@cbre.com

555 Capitol Mall, Suite 100  
Sacramento, CA 95814  
Fax: (916) 446-8778  
www.cbre.com/sms

## PROPERTY INFORMATION:

### Description

Located adjacent to Toys 'R Us, Best Buy and Linens 'N Things at the intersection of Alta Arden, Arden Way and Ethan Way, this new retail building was constructed to showcase the new Men's Wearhouse retail store. This new building provides high identity retail space of  $\pm 4,187$  SF at this corner location. This freestanding building offers a truly exceptional opportunity for a retailer to locate in the extraordinarily tight and highly sought-after Arden Fair trade area. This property is adjacent to and shares reciprocal access with Arden Fair Mall and Market Square Shopping Center and is the number one retail location in the Sacramento Metropolitan Area.

### Space Available

$\pm 4,187$  SF (approximately 44' x 94')

### Zoning

C-2 (General Commercial)

### Parking

Reciprocal with Toys 'R Us, Burger King, Best Buy and Linens 'N Things

### Signage

Property has exclusive pylon sign

## Tenants Located within Half Mile Radius Include:

- Toys 'R Us
- Linens 'N Things
- JC Penney
- Macy's
- United Artists Theaters
- Circuit City
- Sportsmart
- Century Theaters
- Comp USA
- Guitar Center
- Best Buy
- Nordstrom
- Sears
- Barnes & Noble
- Mervyn's
- Kids 'R Us
- Nordstrom Rack
- Party City
- Ulta 3

## DEMOGRAPHICS (2006 est.):

### Population

3 mile 138,969

### Average HH Income

3 mile \$58,200

### Median Income

3 mile \$41,599

## TRAFFIC COUNT:

Alta Arden ('93)	19,184 CPD
Ethan Way ('93)	1,567 CPD
Arden Way	<u>59,860 CPD</u>
Intersection Total	80,611 CPD

© 2006 CB Richard Ellis, Inc. We obtained the information above from sources we believe to be reliable. However, we have not verified its accuracy and make no guarantee, warranty or representation about it. It is submitted subject to the possibility of errors, omissions, change of price, rental or other conditions, prior sale, lease or financing, or withdrawal without notice. We include projections, opinions, assumptions or estimates for example only, and they may not represent current or future performance of the property. You and your tax and legal advisors should conduct your own investigation of the property and transaction. 80613069

**CBRE**  
CB RICHARD ELLIS

# SITE PLAN

# 1701 Ethan Way

NWC ALTA ARDEN & ETHAN WAY  
SACRAMENTO, CALIFORNIA

**FOR LEASE**  
±4,187 SF AVAILABLE

**For Further Information,  
Please Contact:**

**JON SCHULTZ**  
(916) 446-8261  
jon.schultz@cbre.com

**JULAINE JOHNSON**  
(916) 446-8771  
julaine.johnson@cbre.com

555 Capitol Mall, Suite 100  
Sacramento, CA 95814  
Fax: (916) 446-8778  
www.cbre.com/sms

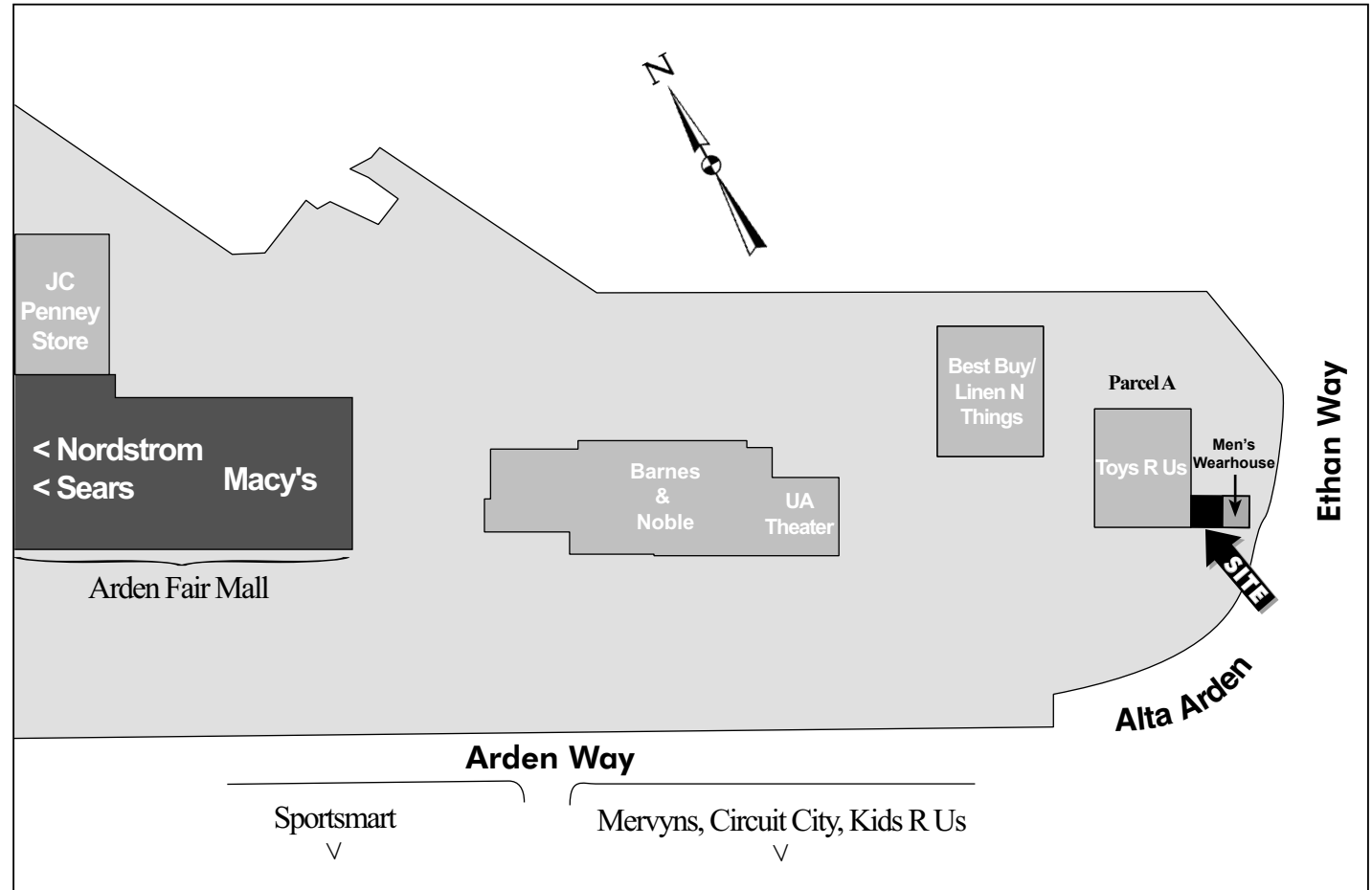

**CBRE**  
CB RICHARD ELLIS

SITE PLAN IS NOT TO SCALE --  
ALL DIMENSIONS ARE APPROXIMATE.

**CBRE**  
CB RICHARD ELLIS

# SITE PLAN

# 1701 Ethan Way

NWC ALTA ARDEN & ETHAN WAY  
SACRAMENTO, CALIFORNIA

**For Further Information,  
Please Contact:**

**JON SCHULTZ**  
(916) 446-8261  
jon.schultz@cbre.com

**JULAINÉ JOHNSON**  
(916) 446-8771  
julaine.johnson@cbre.com

555 Capitol Mall, Suite 100  
Sacramento, CA 95814  
Fax: (916) 446-8778  
www.cbre.com/sms

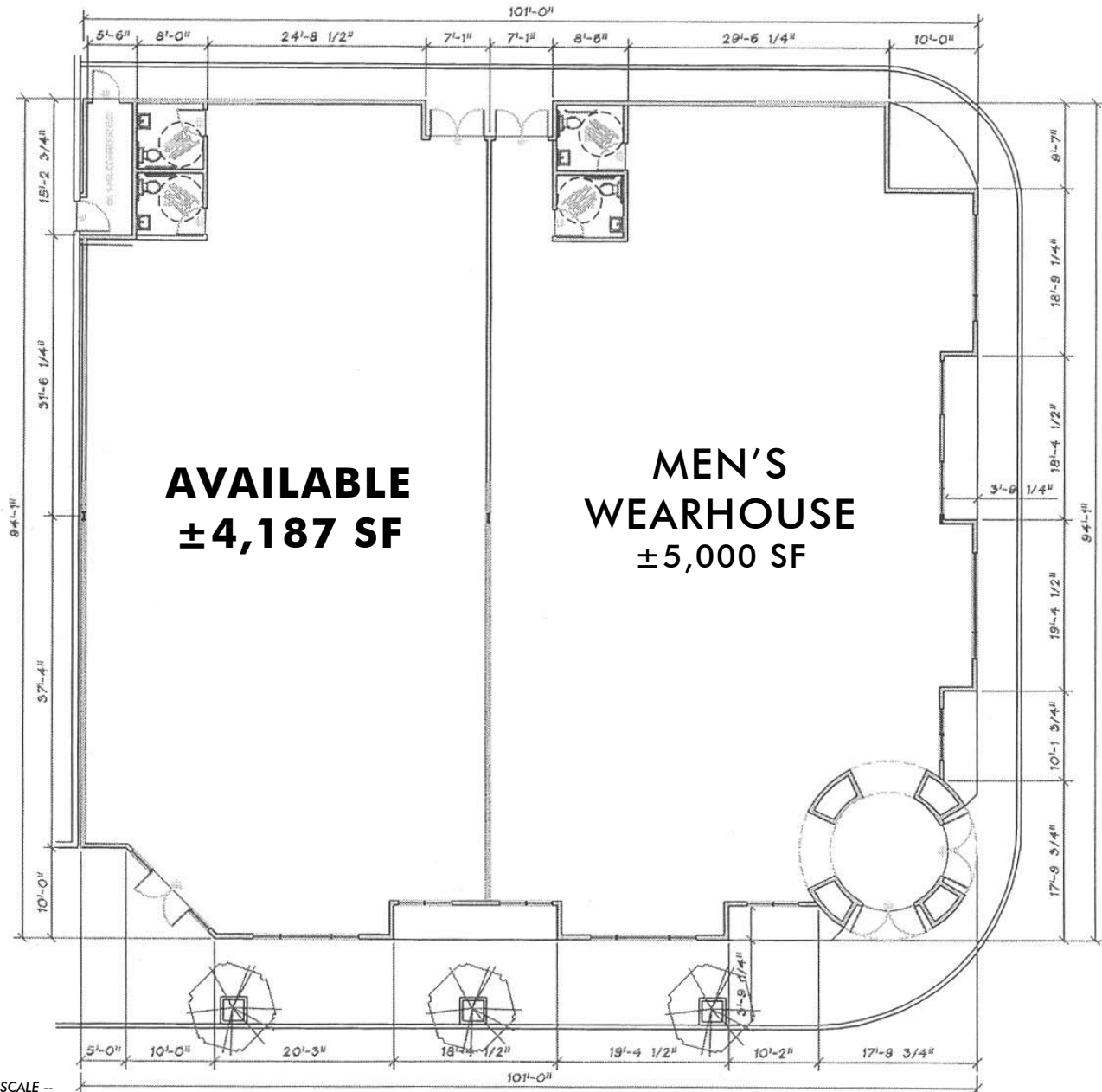

**CBRE**  
CB RICHARD ELLIS

SITE PLAN IS NOT TO SCALE --  
ALL DIMENSIONS ARE APPROXIMATE.



1. Doubletree Hotel
2. Nordstrom, Macy's, Sears, JC Penny
3. Barnes & Noble, U.A. Theaters
4. Best Buy, Linen N Things
5. Sportsmart, Party City
6. Mervyns, Circuit City, Kids R Us
7. Toys R Us
8. Kaiser Hospital
9. Cal Expo
10. Century Theaters
11. Nordstrom Rack, ULTA 3
12. CompUSA
13. Guitar Center

**1701 ETHAN WAY**  
SACRAMENTO, CALIFORNIA

**CBRE**  
CB RICHARD ELLIS